



55025
TANDEM STRIP FIXTURE 2/54
 STRIP FIXTURE

FEATURES

- Ideal for general purpose lighting in a wide variety of applications that require high lumen levels
- Electronic ballast is standard and available in numerous configurations
- Sufficient knockouts are available for electrical and sensor connection
- Install flush with ceiling surface or stem mounted singly or in continuous rows

APPLICATION

Larger warehouses, retail applications, commercial buildings, and work areas.

PRODUCT DETAILS

ELECTRICAL	
Ballast Brand	SUPERIOR LIFE®
Ballast Configuration	N/A
Lamp Type (not included)	F54T5
Number of Lamps	2
Voltage	120-277V
CONSTRUCTION	
Housing	22 Gauge C.R.S
Reflector	86% White Aluminum
Base / Power Supply	Hard Wired
Finish	High Gloss Baked Enamel
PACKAGING	
Master Carton	1pc / 811768025620
Country of Origin	China
HS Tariff	9405.10.6020
CERTIFICATIONS	
N/A	

LIFESPAN	
Warranty	2
DIMENSIONS	
Dimensions (Inches)	48"(L) x 4.4"(W) x 2.1"(H)

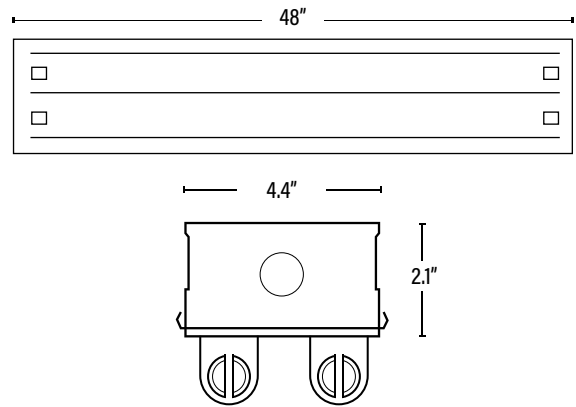

ORDERING

ITEM#	DESCRIPTION	CASE
55025	96" NARROW STRIP FIXTURE FOR 2/54T5/120-277V - SUPERIOR LIFE®	1
ACCESSORIES		
45005	WIRE GUARD FOR 4' STRIP FIXTURE/WHITE	1
55004	WHITE REFLECTOR FOR 4' OR 8' STRIP FIXTURE	1