



Item#: **55029**
48" LED READY WRAP A-ROUND
 LED READY FIXTURE

FEATURES

- Prismatic lens for uniform low glare light.
- Die form cold-rolled steel housing.
- LED ready with non-shunted sockets
- Pre-wired at one end
- Designed for surface or chain mounting

APPLICATION

Ideal for larger warehouses, retail applications, commercial buildings and work areas.

ELECTRICAL

Lamp Type (not included)	T8
Number of Lamps	2
Voltage	120-277V

ENVIRONMENT

Operating Temperature	-4° ~ 122°F
Suitable Location	DAMP
Ingress Protection Rating	IP40

LIFESPAN

Warranty (Years)	2
------------------	----------

CONSTRUCTION

Housing	22 Gauge C.R.S
Lens	Low-Glare Prismatic
Base / Power Supply	Hard Wired
Finish	High Gloss Baked White Enamel

QUALIFICATIONS



Operating temperature may vary depending on the lamps used. • Specifications are subject to change without notice.

PERFORMANCE DATA

Item#: **55029**
48" LED READY WRAP A-ROUND



ITEM INFORMATION

DIMENSIONS (Inches)

Length	48"
Width	8"
Height	3.5"
Weight (Lbs)	--

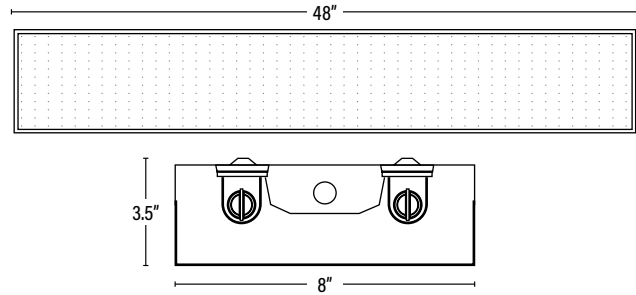

SUPPORTING DOCUMENTS (Grey = not available at this time.)

Product Sheet	VIEW
Install Instructions	VIEW

PACKAGING

		UPC	DIMENSIONS (LxWxH)	GROSS WEIGHT (Lbs)
Master Carton	1	811768025194	48.6" x 8.5" x 3.7"	5.5
Country of Origin	China			
HS Tariff	9405.10.6020			

ORDERING

ITEM#	DESCRIPTION	CASE
55029	LED 48" GENERAL PURPOSE WRAP A-ROUND FOR 2/T8 - SUPERIOR LIFE®	1

ACCESSORIES

54896	360° LOW/HIGH BAY FIXTURE OCCUPANCY PIR SENSOR 30' DIA, 8-40' HEIGHT 800W/1200W • 120/277V - SUPERIOR LIFE®	50
54894	EXTENDER MOUNT FOR SENSOR 54896/54897/54898 - SUPERIOR LIFE®	100

REPLACEMENT PARTS

55029-LC	CLIP ONLY TO SECURE THE LENS FOR GENERAL PURPOSE 8" WRAP A-ROUND	1
550232	LENS ONLY FOR GENERAL PURPOSE 8" WRAP A-ROUND	1

ADDITIONAL INFORMATION:

- Pairs with Superior Life® Direct Wire Single-End or Double-End UL Type B Lamps. Single-end pre-wired fixtures can also be wired double-end by the end-user if needed. Follow specific lamp installation wiring instructions for correct wiring.