



PREMIUM QUALITY LIGHTING

LED VAPOR TIGHT

55156/55158
INSTALL INSTRUCTIONS



WARNING

PLEASE FIND A QUALIFIED ELECTRICIAN FOR INSTALLATION. Please read the instructions before you install and use the luminaire.

WARNING, CAUTIONS AND OPERATING INSTRUCTIONS

- To reduce the risk of death, personal injury or property damage from fire, electric shock, falling parts, cuts/abrasions, and other hazards read all warnings and instructions included with and on the fixture box and all fixture labels.
- Before installing, servicing, or performing routine maintenance upon this equipment, follow these general precautions.
- Commercial installation, service and maintenance of luminaires should be performed by a qualified licensed electrician.
- For The installation: If you are unsure about the installation or maintenance of the luminaires, consult a qualified licensed electrician and check your local electrical code.
- To prevent wiring damage or abrasion, do not expose wiring to edges of sheet metal or other sharp objects.
- Do not make or alter any open holes in an enclosure of wiring or electrical components during kit installation.

WARNING: RISK OF FIRE OR ELECTRICAL SHOCK

- Turn off electrical power at fuse or circuit breaker box before wiring fixture to the power supply.
- Turn off the power when you perform any maintenance.
- Verify that supply voltage is correct by comparing it with the luminaire label information.
- Make all electrical and grounded connections in accordance with the National Electrical Code and any applicable local code requirements.
- All wiring connections should be capped with UL approved wire connectors.

CAUTION: RISK OF INJURY

- Avoid direct eye exposure to the light source while it is on.
- Account for small parts and destroy packing material, as these may be hazardous to children.
- Suitable for Wet locations.

INSTALLATION



1. Locate drill holes for mounting brackets shown in Figure 1. Use hardware found in hardware kit. Mount bracket to surface.
2. Pre-attached lens buckles to housing
3. Detach LED tray from fixture as shown in Figure 2.
4. Attach body to mounting clips as shown in Figure 3.
5. Locate tether when opening to install fixture body as shown in Figure 4.
6. Snap connect tether to gear tray before making electrical connection as shown in Figure 5.
7. Connect power to driver. Follow General Wiring Diagram below.
8. Reattach LED tray to fixture by reversing step 2.
9. Install lens as shown in Figure 6. Use the buckles provided in hardware kit to securely attach lens to body fixture.
10. Restore power.

IMAGES FOR REFERENCE ONLY

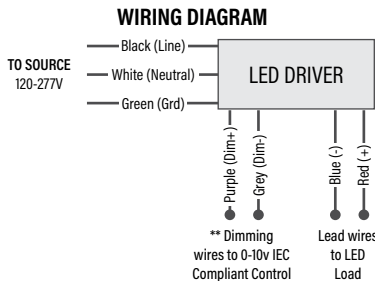
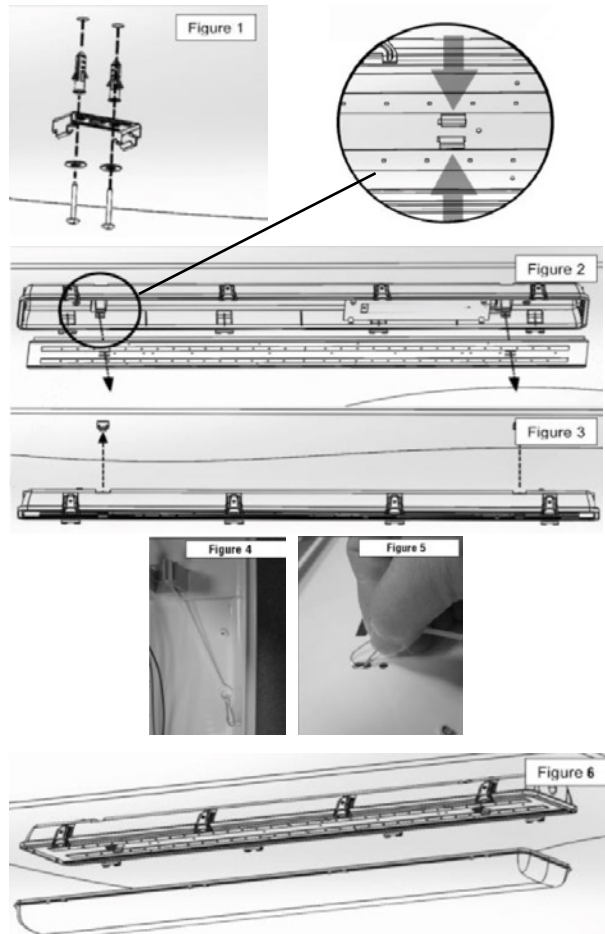

Please check DLC website for the most current list of approved items - www.designlights.org
Published lumens on LED products are approximate and may vary slightly.