



Item#: **55645**  
**48" LED READY WRAP A-ROUND**  
 LED READY FIXTURE

**FEATURES**

- Prismatic lens for uniform low glare light.
- Die form cold-rolled steel housing.
- LED ready with non-shunted sockets
- Pre-wired at both ends
- Works with both Single-End and Double-End Direct Wire lamps
- Designed for surface or chain mounting

**APPLICATION**

Ideal for larger warehouses, retail applications, commercial buildings and work areas.

**ELECTRICAL**

Lamp Type (not included)	T8
Number of Lamps	2
Voltage	120-277V

**ENVIRONMENT**

Operating Temperature	-4° ~ 122°F
Suitable Location	<b>DAMP</b>
Ingress Protection Rating	IP40

**LIFESPAN**

Warranty (Years)	<b>2</b>
------------------	----------

**CONSTRUCTION**

Housing	22 Gauge C.R.S
Lens	Low-Glare Prismatic
Base / Power Supply	Hard Wired
Finish	High Gloss Baked White Enamel

**QUALIFICATIONS**



*Operating temperature may vary depending on the lamps used. • Specifications are subject to change without notice.*

PERFORMANCE DATA

Item#: **55645**  
**48" LED READY WRAP A-ROUND**



**DIMENSIONS** (Inches)

Length	48"
Width	8"
Height	3.5"
Weight (Lbs)	--

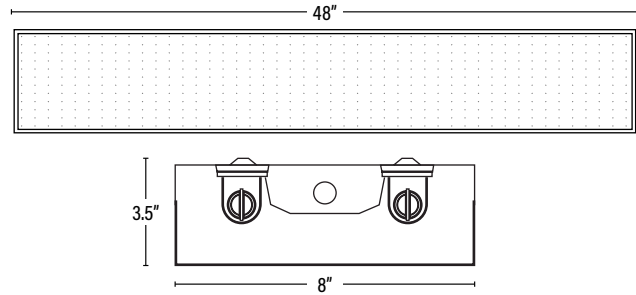

**SUPPORTING DOCUMENTS** (Grey = not available at this time.)

Product Sheet	VIEW
Install Instructions	VIEW

**PACKAGING**

		UPC	DIMENSIONS (LxWxH)	GROSS WEIGHT (Lbs)
Master Carton	1	811768029543	48.6" x 8.5" x 3.7"	5.5
Country of Origin	China			
HS Tariff	9405.10.6020			

**ORDERING**

ITEM#	DESCRIPTION	CASE
55645	LED 48" GENERAL PURPOSE WRAP A-ROUND FOR 2 T8/DE - SUPERIOR LIFE®	1

**ACCESSORIES**

54896	360° LOW/HIGH BAY FIXTURE OCCUPANCY PIR SENSOR 30' DIA, 8-40' HEIGHT 800W/1200W • 120/277V - SUPERIOR LIFE®	50
54894	EXTENDER MOUNT FOR SENSOR 54896/54897/54898 - SUPERIOR LIFE®	100

**REPLACEMENT PARTS**

550232	LENS ONLY FOR GENERAL PURPOSE 8" WRAP A-ROUND	1
--------	---	---

**ADDITIONAL INFORMATION:**

- Pairs with Superior Life® Direct Wire Single-End or Double-End UL Type B Lamps. Follow specific lamp installation wiring instructions for correct wiring.