



Item#: **55647**
LED 2X4 TROFFER - 3 LAMP
LED READY FIXTURE

FEATURES

- Uses 30% less energy than a linear fluorescent troffer
- Die formed, and rigidly fabricated
- Smooth edges for easy handling and no exposed fasteners
- Prismatic acrylic diffuser
- Door hinges are on either side for easy re-lamping
- Positive locking cam action latches with matching finish
- LED ready with non-shunted sockets
- Pre-wired at both ends
- Works with both Single-End and Double-End Direct Wire lamps
- Exposed T-grid ceiling and recessed ceiling mount

APPLICATION

Ideal for offices, retail, commercial buildings and work areas.

ELECTRICAL

Lamp Type (not included)	T8
Number of Lamps	3
Voltage	120-277V

ENVIRONMENT

Operating Temperature	-4° ~ 122°F
Suitable Location	DAMP
Ingress Protection Rating	IP40

LIFESPAN

Warranty (Years)	2
------------------	----------

CONSTRUCTION

Housing	24 Gauge Steel
Base / Power Supply	Hard Wired
Finish	High Gloss Baked White Enamel

QUALIFICATIONS



Operating temperature may vary depending on the lamps used. • Specifications are subject to change without notice.

Item#: **55647**
LED 2X4 TROFFER - 3 LAMP



ITEM INFORMATION

DIMENSIONS (Inches)

Length	48"
Width	24"
Height	3.3"
Weight (Lbs)	--

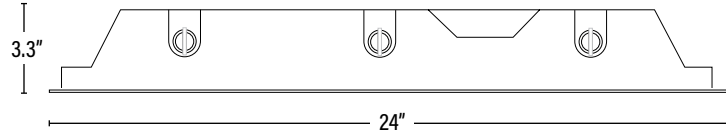

SUPPORTING DOCUMENTS (Grey = not available at this time.)

Product Sheet	VIEW
Install Instructions	VIEW

PACKAGING

		UPC	DIMENSIONS (LxWxH)	GROSS WEIGHT (Lbs)
Master Carton	1	--	49.2" x 24.4" x 3.5"	18.7
Country of Origin	China			
HS Tariff	9405.10.6020			

ORDERING

ITEM#	DESCRIPTION	CASE
55647	LED 2X4 TROFFER FOR 3 T8	1

REPLACEMENT PARTS

552728	REPLACEMENT LENS FOR LED 2X4 TROFFER	1
--------	--------------------------------------	---

ADDITIONAL INFORMATION:

- Pairs with Direct Wire Single-End or Double-End UL Type B Lamps. Follow specific lamp installation wiring instructions for correct wiring.