



Item#: **56028**
LED 96" TANDEM STRIP FIXTURE
 LED READY FIXTURE

FEATURES

- Use 30% less energy than a traditional fluorescent fixture
- Die formed, and rigidly fabricated
- LED ready with non-shunted sockets
- Pre-wired at one end
- Designed for pendant or chain mounting, adjustable cable

APPLICATION

Ideal for larger warehouses, retail applications, commercial buildings and work areas.

ELECTRICAL

Lamp Type (not included)	T8
Number of Lamps	4
Voltage	120-277V

ENVIRONMENT

Operating Temperature	-4° ~ 122°F
Suitable Location	DAMP
Ingress Protection Rating	IP40

LIFESPAN

Warranty (Years)	2
------------------	----------

CONSTRUCTION

Housing	22 Gauge C.R.S
Base / Power Supply	Hard Wired
Finish	High Gloss Baked Black Enamel

QUALIFICATIONS



Operating temperature may vary depending on the lamps used. • Specifications are subject to change without notice.

Item#: **56028**
LED 96" TANDEM STRIP FIXTURE



DIMENSIONS (Inches)

Length	96"
Width	4.4"
Height	2.1"
Net Weight (Lbs)	--

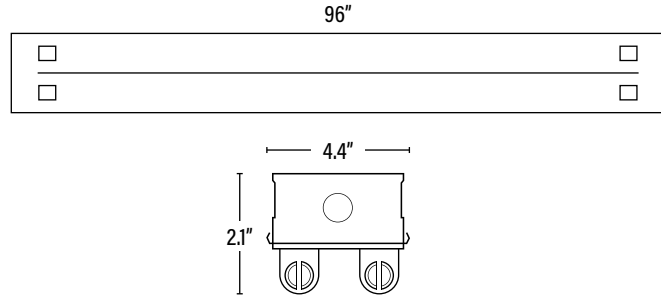

SUPPORTING DOCUMENTS (Grey = not available at this time.)

Product Sheet	VIEW
Install Instructions	VIEW

PACKAGING

	UPC	DIMENSIONS (LxWxH)	GROSS WEIGHT (Lbs)	
Master Carton	1	811768029222	97.6" x 4.7" x 2.3"	8.8
Country of Origin	China			
HS Tariff	9405.10.6020			

ORDERING

ITEM#	DESCRIPTION	CASE
56028	LED 96" TANDEM STRIP FIXTURE FOR 4/T8/BLACK - SUPERIOR LIFE®	1

ACCESSORIES

54896	360° LOW/HIGH BAY FIXTURE OCCUPANCY PIR SENSOR 30' DIA, 8-40' HEIGHT 800W/1200W • 120/277V - SUPERIOR LIFE®	50
54894	EXTENDER MOUNT FOR SENSOR 54896/54897/54898 - SUPERIOR LIFE®	100
54711	PRE-WIRED NON-SHUNTED SOCKETS FOR A 8FT STRIP FIXTURE - SUPERIOR LIFE®	10

ADDITIONAL INFORMATION:

- Pairs with Superior Life® Direct Wire Single-End or Double-End UL Type B Lamps. Single-end pre-wired fixtures can also be wired double-end by the end-user if needed. Follow specific lamp installation wiring instructions for correct wiring.

ITEM INFORMATION