

Item#: **83419**
LED V5 SHOE BOX RETROFIT
 WILDLIFE FRIENDLY RETROFIT

FEATURES

- Reduce energy and maintenance costs up to 80% compared to traditional lamps, almost free of maintenance
- Intelligent thermal control.
- Light weight, durable.

APPLICATION

Replaces existing metal halide and HPS lamps in street light, wall packs, canopy and high bay fixtures.

ELECTRICAL

Wattage	75W
Voltage	100-277V
Current	N/A
Power Factor	0.9
Total Harmonic Distortion (THD)	20%

LIGHTING PERFORMANCE

Lumens	2380
Lumens Per Watt (Lm/W)	32
Color Temperature (CCT)	AMBER / 590-610 nm
Color Rendering (CRI)	N/A
R9 (Red Value)	--
R13 (Skin Tones)	--
Beam Angle	120°
Light Distribution	Type VS
Dimmable Lighting Control	

ENVIRONMENT

Operating Temperature	-13° ~ 131°F
Suitable Location	DRY
Ingress Protection Rating	IP20
Fixture Type	Enclosed

LIFESPAN

Average Life (Hours)	50,000
Warranty (Years)	5

COMPONENTS

LED Light Source	CREE XB-D (Amber color)
Driver	Meanwell CEN-75-24

CONSTRUCTION

Housing	Aluminum Heat-Sink
Base / Power Supply	Hard Wired
Finish	Silver

QUALIFICATIONS



Published lumens on LED products are approximate and may vary slightly. - Specifications are subject to change without notice.

PERFORMANCE DATA

Item#: **83419**
LED V5 SHOE BOX RETROFIT



DIMENSIONS (Inches)

Length	6.1"
Width/Diameter	5.1"
Height	2.3"
Net Weight (Lbs)	--

SUPPORTING DOCUMENTS (Grey = not available at this time.)

Product Sheet	VIEW
Install Instructions	VIEW
IES Download from Web Item	VIEW
LM79	VIEW
LM80	VIEW

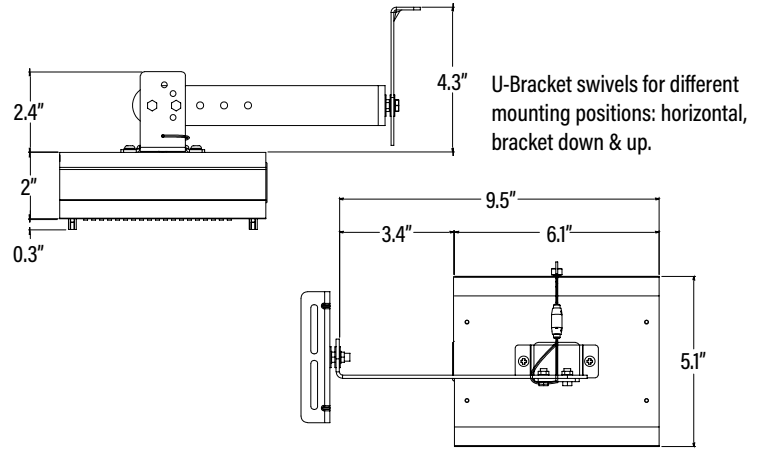

PACKAGING

		UPC	DIMENSIONS (LxWxH)	GROSS WEIGHT (Lbs)
Master Carton	6	10811768025382	--	--
Individual Box	1	811768025385	--	--
Country of Origin	China			
HS Tariff	9405.10.6020			

ORDERING

ITEM#	DESCRIPTION	CASE
83419	LED 75W SHOE BOX RETROFIT/120°/AMBER/100-277V/V5 - SUPERIOR LIFE®	6

REPLACEMENT PARTS

CEN-75-24	REPLACEMENT DRIVER	1
-----------	--------------------	---

ITEM INFORMATION