



Item#: **84333**

## LED COMPASS HIGH BAY

HIGH-BAY LUMINAIRES FOR COMMERCIAL AND INDUSTRIAL BUILDINGS

### FEATURES

- Die cast aluminum for better heat dissipation
- Dust proof and anti-corrosive
- Modern design
- High efficiency driver with built-in surge protection
- Includes a 12V DC AUX wire

### APPLICATION

Ideal for commercial and industrial applications; malls, warehouses, factories, retail stores, athletic facilities, workshops, airports, and large areas.

### ELECTRICAL

Wattage	199W
Voltage	277-480V
Power Factor	0.9
Total Harmonic Distortion (THD)	7.2

### LIGHTING PERFORMANCE

Lumens	33131
Lumens Per Watt (LPW)	167
Color Temperature (CCT)	5000K
Color Rendering (CRI)	73
R9 (Red Value)	-16
Beam Angle	110°
Light Distribution	Type VS
BUG Rating (Backlight, Uplight, and Glare)	B5 - U3 - G2
Dimmable Lighting Control	<i>Dimmable</i> 0-10V, Range 10% - 100%

### ENVIRONMENT

Operating Temperature	-22°~ 122°F
Suitable Location	<b>WET</b>
Ingress Protection Rating	IP65

### LIFESPAN

Average Life (Hours)	50,000
Warranty (Years)	<b>5</b>

### COMPONENTS

LED Light Source	SMD 2835
Driver	SS-240SA-56BH

### CONSTRUCTION

Housing	Aluminum
Lens	Tempered Glass
Base / Power Supply	Hard Wired
Finish	Black

### QUALIFICATIONS

Model Number	CHB3-200-D-HV-50K-170S
--------------	------------------------



Visit [www.designlights.org/search](http://www.designlights.org/search) to confirm qualification. • Published lumens on LED products are approximate and may vary slightly. • Specifications are subject to change without notice.

Item#: **84333**  
**LED COMPASS HIGH BAY**



ITEM INFORMATION

**DIMENSIONS** (Inches)

Width/Diameter (MOD)	10.2"
Height	5.7"
Net Weight (Lbs)	5.8

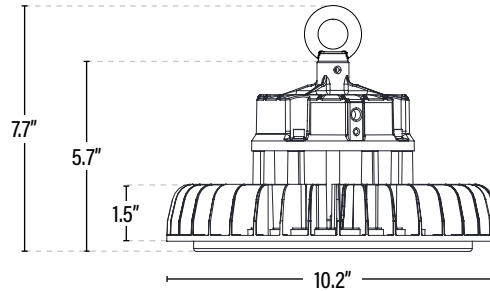

**SUPPORTING DOCUMENTS** (Grey = not available at this time.)

Product Sheet	VIEW
Install Instructions	VIEW
IES Download from Web Item	VIEW
LM79	VIEW
LM80	VIEW

**PACKAGING**

		UPC	DIMENSIONS (LxWxH)	GROSS WEIGHT (Lbs)
Master Carton	1	811768022131	--	--
Country of Origin	China			
HS Tariff	9405.10.6020			

**ORDERING** Qualification Model # CHB3-200-D-HV-50K-170S

ITEM#	DESCRIPTION	CASE
84333	LED COMPASS HIGH BAY/200W/50K/DIMM/480V/BLK - DLC®	1

**ACCESSORIES**

90372	ADJUSTABLE ANGLE MOUNTING BRACKET FOR 100-240W COMPASS HIGH BAY	20
90360	16IN ALUMINUM REFLECTOR FOR COMPASS HIGH BAY	1
90362	16IN ACRYLIC REFLECTOR FOR COMPASS HIGH BAY	1
90363	16IN ACRYLIC BOTTOM LENS FOR ACRYLIC REFLECTOR FOR COMPASS HIGH BAY	1
90396*	78IN WATERPROOF CONNECTOR AND CORD/BLACK 18AWG/300V	50

**REPLACEMENT PARTS**

903814	M12 REPLACEMENT EYELET FOR LED COMPASS HIGH BAYS	1
SS-240SA-56BH	REPLACEMENT LED DRIVER	1

\* Waterproof Connector (90396) are compatible as long as the input voltage does not exceed the rating of the accessory.

**ADDITIONAL INFORMATION:**

- Safety cable not included, must be provided by installer.
- Power and dimming cord length approximately 72"
- Multiple screw holes are conveniently placed throughout the top of the fixture to connect occupancy sensors and reflectors.

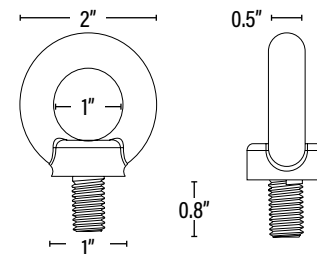

**M12**  
**Eyelet Dimensions**