

LED LOW PROFILE CANOPY • 75W/100W/130W

INSTALL INSTRUCTIONS



PLEASE FIND A QUALIFIED ELECTRICIAN FOR INSTALLATION. Please read the instructions before you install and use the luminaire.

- To prevent personal injury or product damage only licensed electricians should install.
- To avoid electric shock or component damage disconnect power before attempting installation or servicing.
- Do not make or alter any open holes in an enclosure of wiring or electrical components during kit installation.
- Check if the local voltage range corresponds with the working voltage of the fixture.
- Keep the fixture away from fire, electric shock, or vibration.
- To prevent wiring damage or abrasion, do not expose wiring to edges of sheet metal or other sharp objects

! WARNING DISCONNECT POWER BEFORE INSTALLING OR SERVICING.

- 1: Drill holes into the surface fixture is to be mounted on. (Ceiling, Sheet Metal Box or Sheet Metal Support)
- 2: Install safety rope and connect the cables. Black=L, White=N, Green=G. Make sure wiring is placed inside junction box.
- 3: Install the screws.
- 4: The installation is complete.

INSTALLATION ON CEILING

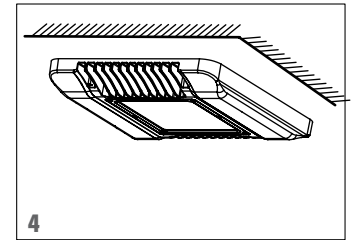
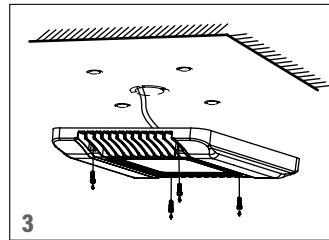
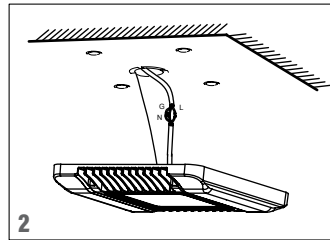
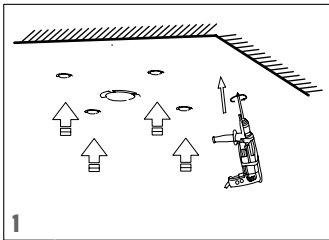

INSTALLATION INTO AN EXISTING SHEET METAL BOX (Not Included)

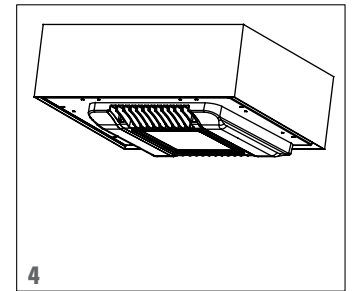
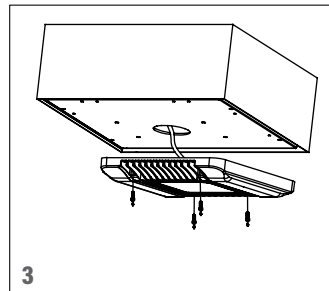
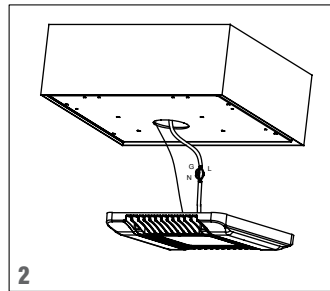
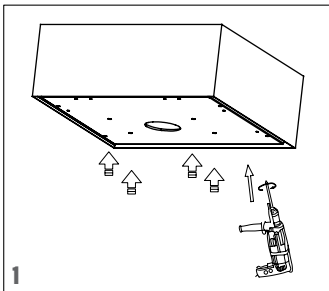

INSTALLATION ONTO EXISTING SHEET METAL SUPPORT (Not Included)

