



Item#: **90371**
BI-LEVEL PIR SENSOR / 480V
FIXTURE ACCESSORY

FEATURES

- Slim, low-profile sensor.
- Provides multi-level control based on motion and/or daylight contribution.
- 30' range sensitivity detector.

APPLICATION

For use with 480V Compass High Bays

360° TOP AND SIDE VIEW

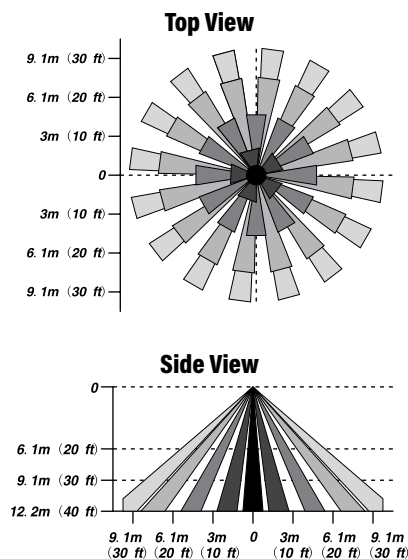

ELECTRICAL

Voltage	347-480V	
Load Requirements	Resistive / Halogen	1500W @ 347V / 1500W @ 480V
	Fluorescent Ballast	1500VA @ 347V / 1500VA @ 480V
	Electronic Ballast (LED/CFL)	5A @ 347V / 5A @ 480V

PERFORMANCE

Detection Angle	360°
Detection Radius	30'
Max. Mounting Height	40'
Dim Control Output	0-10V Dimming

ENVIRONMENT

Operating Temperature	-40° ~ 167°F
Suitable Location	WET
Ingress Protection Rating	IP65

LIFESPAN

Warranty (Years)	5
------------------	----------

CONSTRUCTION

Housing	PC
Mounting	Hard Wired
Finish	White

QUALIFICATIONS



Specifications are subject to change without notice.

DIMMING FUNCTION

The function inside the motion sensor for tri-level control, for areas that require a light change before switch-off. The sensor has 3 levels of light: 100%, dimmed light (when natural light is insufficient) and off. Selectable waiting time; motion hold-time and stand-by period; selectable daylight threshold and freedom of detection area.

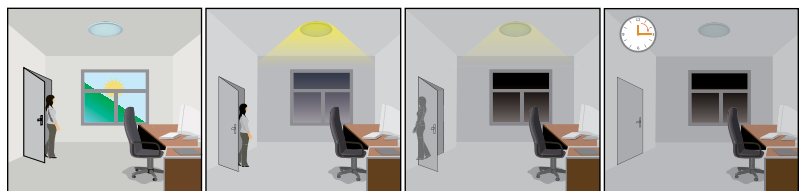

With sufficient natural light, the light does not switch on when presence is detected.

With insufficient natural light, the sensor switches on the light automatically when presence is detected.

After hold-time, the light dims to stand-by level if the surrounding natural light is below the daylight threshold.

Light switches off automatically after the stand-by period elapses.

Item#: **90371**
BI-LEVEL PIR SENSOR / 480V



ITEM INFORMATION

DIMENSIONS (Inches)

Length	
Width	See Line Drawings
Height	
Net Weight (Lbs)	--

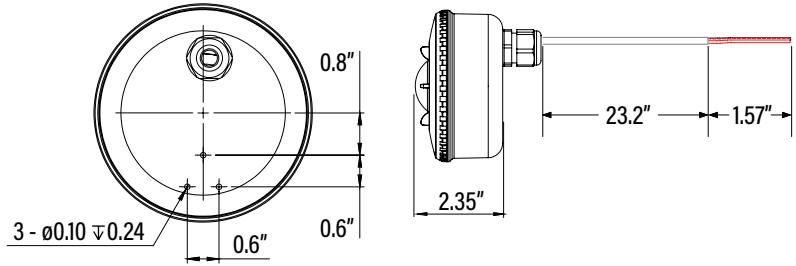

SUPPORTING DOCUMENTS (Grey = not available at this time.)

Product Sheet	VIEW
---------------	------

PACKAGING

		UPC	DIMENSIONS (LxWxH)	GROSS WEIGHT (Lbs)
Master Carton	10	--	--	--
Individual Box	1	--	--	--
Country of Origin	China			
HS Tariff	--			

ORDERING

ITEM#	DESCRIPTION	CASE
90371	MICROWAVE MOTION SENSOR FOR COMPASS HIGH BAY/480V/1-10V DIMMING/KIT	10

ADDITIONAL INFORMATION:

Item may be special order; please consult with sales representative.

MOUNTING

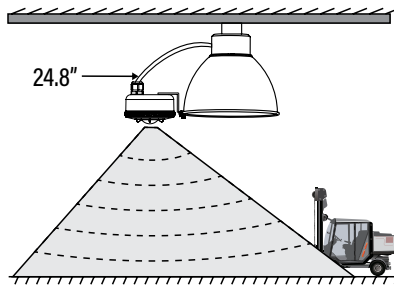
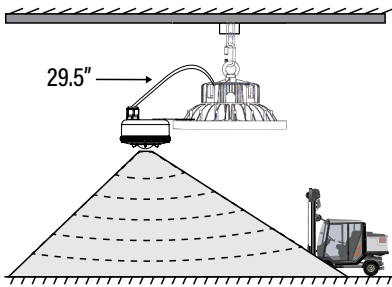

MOUNTING DIRECT TO J-BOX

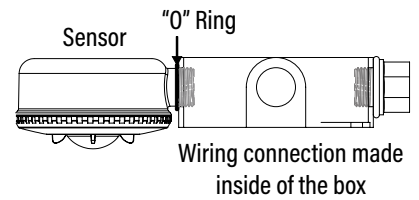

WIRING

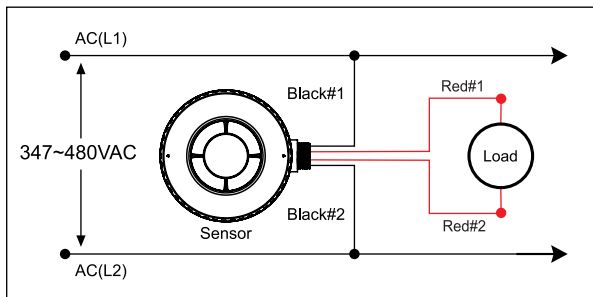

Wiring with non-dimming ballast or LED driver.
ON/OFF Sensor

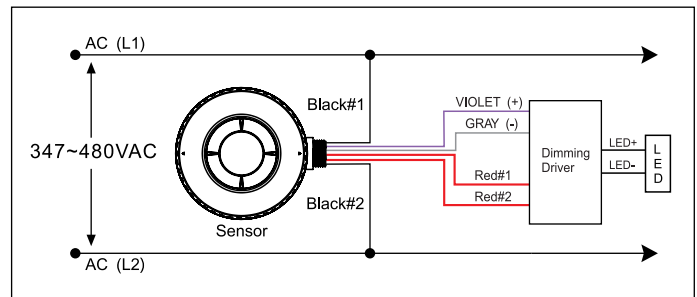

Wiring with dimming ballast or LED driver.
Dimming Sensor