



TECHNICAL DATA SHEET

FEATURES

- Optimum performance while maintaining a high level of efficiency
- Ballasts comply with the OEM requirements of the top light fixture manufacturers
- Multi voltage technology and class A sound rating
- Automatic restart capability and end of life lamp protection

APPLICATION

Used in offices, warehouses, manufacturing facilities, or wherever a ballast is required.

91978

HPS BALLAST KIT

ELECTRONIC BALLAST

PRODUCT DETAILS

ELECTRICAL	
Wattage	400W
Input Voltage	120-277V
ANSI Code	S51
ENVIRONMENT	
Minimum Starting Temperature	-30°C
LIFESPAN	
Warranty (Years)	1
CONSTRUCTION	
Housing	Steel
Base/Power Supply	Hard Wired
CERTIFICATIONS	



PACKAGING	
Master Carton	1pc / 10811768023869
Individual Box	811768023862
Country of Origin	China
HS Tariff	8504.10.0000
DIMENSIONS	
Dimensions (Inches)	4.7"(L) x 5.5"(W) x 4.3"(H)

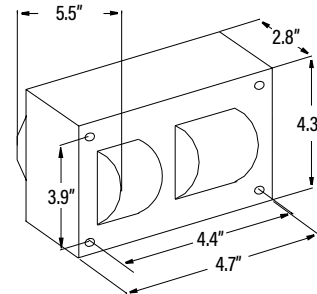

ORDERING

ITEM#	DESCRIPTION	CASE
91978	BALLAST KIT 400W HPS S51 - 120/208/240/277V - SUPERIOR LIFE®	1

WIRING DIAGRAM AND CAPACITOR DIMENSIONS

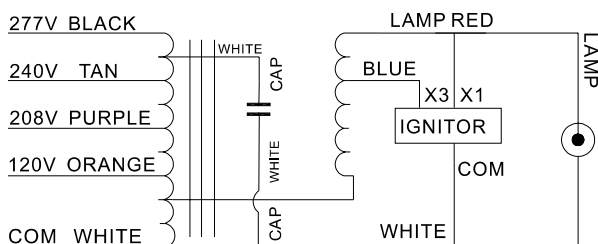

CAPACITOR
 Rated Temp: 105°C
 Height: 4.21"
 Width/Diameter: 2.13"

IGNITOR HPS 200W-400W
 Rated Temp: 105°C
 BLT: 2FT

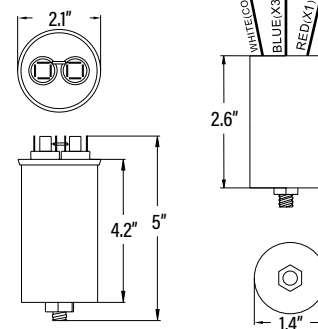

Electrical specifications on next page.

www.PQLighting.com

© P.Q.L., INC. • 2285 WARD AVENUE • SIMI VALLEY, CA 93065 • 800.323.8107 • FAX: 877.619.7053

GO GREEN

1017

91970

ELECTRICAL SPECIFICATIONS



TECHNICAL DATA SHEET

INPUT VOLTS	120	208	240	277
Regulation				
Line Volts	±5%	±5%	±5%	±5%
Lamp Watts	±10%	±10%	±10%	±10%
Power Factor (min)	80%	80%	80%	80%
Input watts	520W	520W	520W	520W
NOM. Open Circuit Voltage	190V	190V	190V	190V

LINE CURRENT (Amps)				
Operating	4.00	2.20	2.00	1.70
Open Circuit	1.70	1.10	0.90	0.80

UL TEMPERATURE RATINGS				
Insulation Class	H(180°C)	H(180°C)	H(180°C)	H(180°C)
Temperature Code	I	I	I	I
Min. Starting Temperature	-20°C -30°C	-20°C -30°C	-20°C -30°C	-20°C -30°C

CAPACITOR SPECIFICATIONS				
Microfarads	55 uf	55 uf	55 uf	55 uf
Volts (min.)	300V	300V	300V	300V

60Hz TEST PROCEDURES				
High Potential Test 1 Minute	2000V	2000V	2000V	2000V
High Potential Test 1 Second	2500V	2500V	2500V	2500V
Secondary Open Ckt Voltage (V)	170-240	170-240	170-240	170-240
Secondary Current Shorted (A)	3.90-7.20	3.90-7.20	3.90-7.20	3.90-7.20
Input Open Circuit Current (A)	1.00-3.00	0.50-2.50	0.40-2.40	0.30-2.30
Input Short Circuit Current (A)	2.50-4.50	1.10-3.10	1.00-3.00	0.80-2.80

CORE AND COIL SPECIFICATIONS	
Dimension A	2.76 in
Dimension B	5.51 in
Coil Material (Pri./Sec.)	AL/AL