

# LED SNAP & GO™ KIT • MAGNETIC MODULES

## INSTALL INSTRUCTIONS



**PLEASE FIND A QUALIFIED ELECTRICIAN FOR INSTALLATION.** Please read the instructions before you install and use the Snap & Go™ kit.

### FOLLOW ALL SAFETY INSTRUCTIONS

**DANGER – RISK OF SHOCK – DISCONNECT POWER BEFORE INSTALLATION**

**WARNING – Risk of fire or electric shock.** LED Retrofit Kit installation requires knowledge of luminaires electrical systems. If not qualified, do not attempt installation. Product must be installed in accordance with the National Electrical Code or your local electrical code. If you are not familiar with these codes and requirements, contact a qualified electrician.

**WARNING – Risk of fire or electric shock.** Install this kit only in the luminaires that have the construction features and dimensions shown in the photographs and/or drawings and where the input rating of the retrofit kit does not exceed the input rating of the luminaire.

Do not make or alter any open holes in an enclosure of wiring or electrical components during kit installation.

**WARNING –**To prevent wiring damage or abrasion, do not expose wiring to edges of sheet metal or any other sharp objects.

**WARNING – Risk of fire or electric shock.** Luminaire wiring and electrical parts may be damaged when installing of retrofit kit hardware. Check for enclosed wiring and components.

**WARNING – Risk of fire or electric shock.** Check the existing wiring for damage before installing upgrade kit.

Do not install if existing wires are damaged.

Suitable for dry locations and for use in totally enclosed luminaires. Do not use with dimmers unless dimmable driver installed.

This device is not for use with emergency fixtures.

**! WARNING DISCONNECT POWER BEFORE INSTALLING OR SERVICING.**

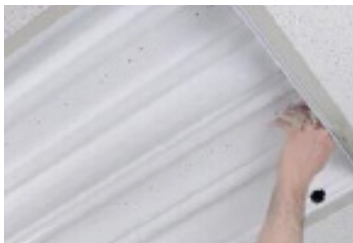

1. Remove the lens (if required) and original fluorescent tube(s) on existing fixture. *(Recycle tubes according to state specific recycling guidelines).*



2. Disconnect wires and remove the existing ballast.



3. Remove other irrelevant pieces of the fixture.

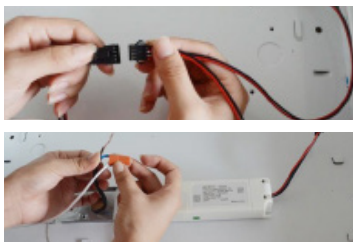

4. Refer to wiring instructions on pages 2 and 3.



5. Fasten the magnetic strip and driver in the fixture.



6. Affix caution labels to fixture so they are visible to bulb installers. Replace the cover of the driver. Replace lens if needed.

### WIRING DIAGRAM - MAGNETIC BALLAST

1. If the existing light fixture has a magnetic ballast and starter, disconnect and rewire the wires according to the diagram below (see Fig. 1 and Fig. 2).

FIG. 1: Original Circuit

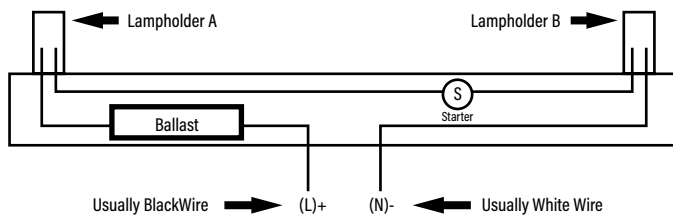
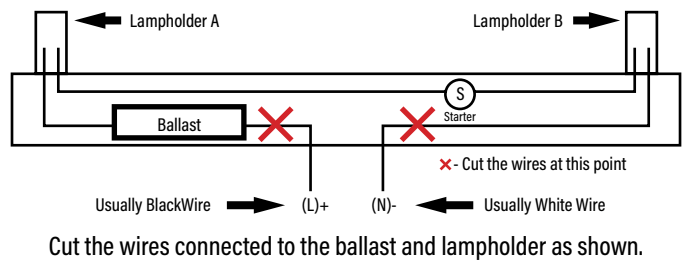

FIG. 2: After Retrofit



### WIRING DIAGRAM - ELECTRONIC BALLAST

2. If the light fixture is providing with electronic ballast, disconnect and rewire the wires at the point as shown in the following figures. (see Fig. 3 and Fig. 4).

FIG. 3: Original Circuit

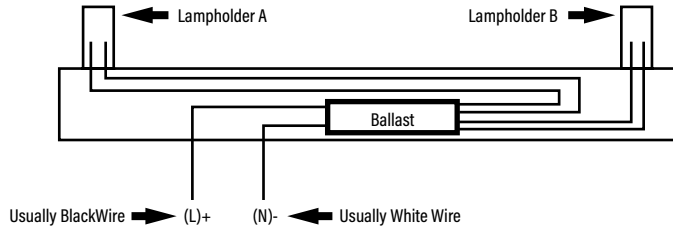
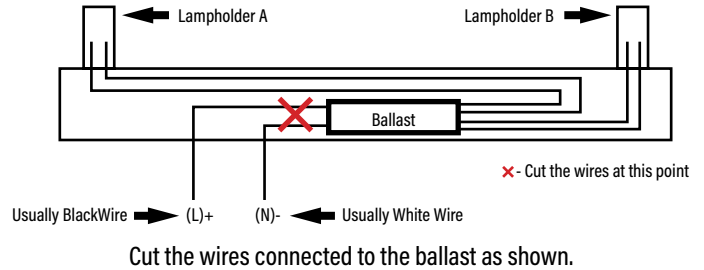

FIG. 4: After Retrofit



### WIRING DIAGRAM - INSTANT START BALLAST

3. If the existing light fixture has an instant start ballast, disconnect and rewire the wires at the points as shown in the following figures (see Fig. 5 and Fig. 6).

FIG. 5: Original Circuit

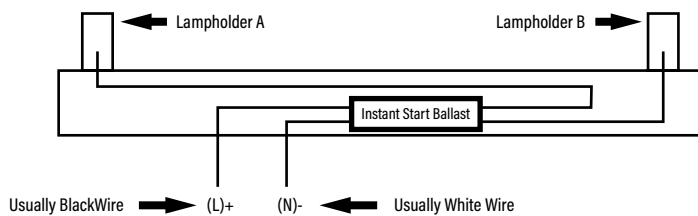
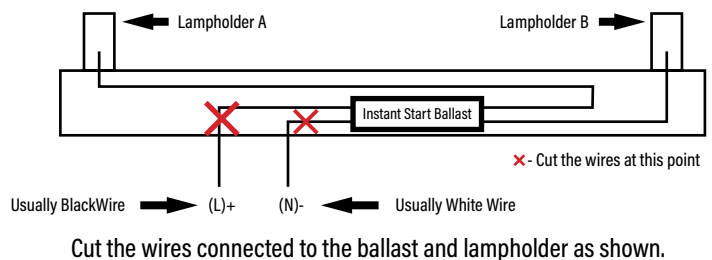

FIG. 6: After Retrofit



## FINAL WIRING DIAGRAM

After removing the ballast, lampholders, and starter (if needed), the light fixture should be wired like the below figure (see figure 7).

FIG. 7: Final Wiring

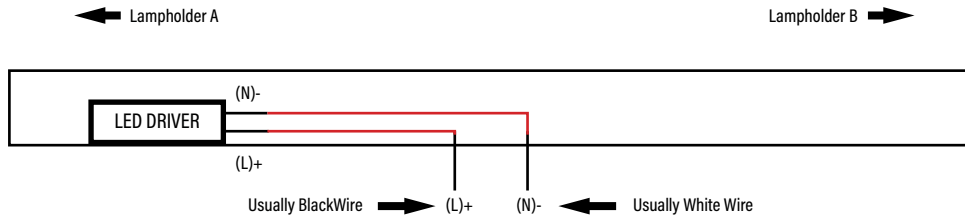

## INSTALLATION CONNECTION DIAGRAMS

FIG. 8: Non-Dimmable

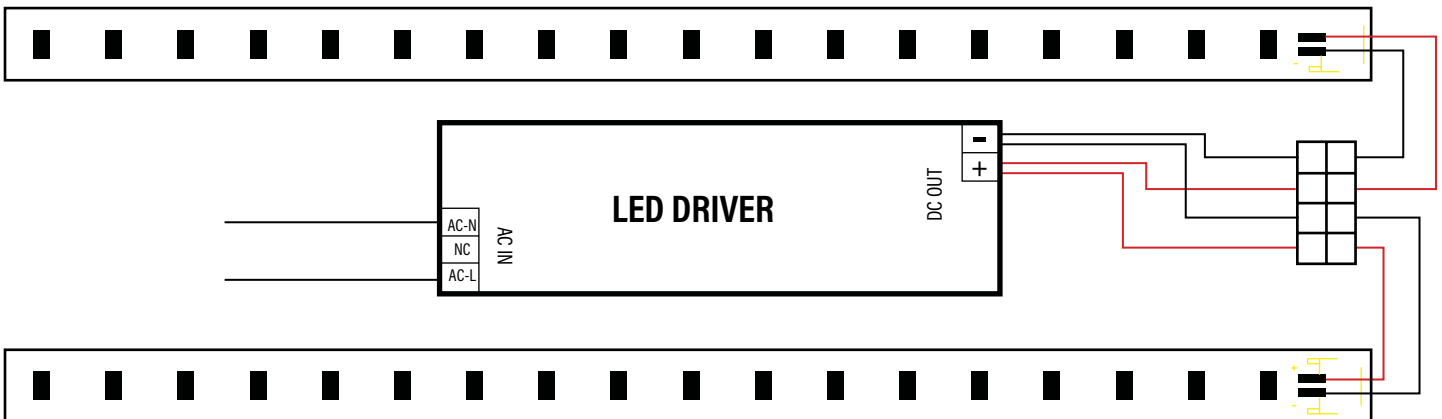

FIG. 9: Dimmable

