

# LINEAR ARCHITECTURAL/WET LOCATION

## INSTALLATION INSTRUCTIONS



**PLEASE USE A QUALIFIED ELECTRICIAN FOR INSTALLATION.** Read the instructions before installing or use of the luminaire.

**CAUTION:** This equipment is intended to be installed only by qualified personnel. The installation must be made in accordance with the current edition of the National Electrical Code (NEC) and all applicable state and local building codes. The final installation must be approved by the appropriate, qualified electrical/ building inspector(s). Improper installation may result in a fire or electrical hazard. Ensure the electrical power to the circuit has been disconnected before installing the electrical system.

### SAFETY INSTRUCTIONS

- Read this installation guide prior to attempting installation. Always turn OFF the main power before starting your installation. Consult a qualified electrician before installation. Installation should be carried out by a qualified electrician.
- Use only connectors compatible with the luminaire fixture.
- Install all parts of the luminaire at least 5 feet above the finished floor.
- Maintain a minimum clearance of 5 inches between the luminaire and any combustible materials, such as curtains or blinds.
- Only energize luminaire fixtures—do not attempt to power any other devices.
- To reduce the risk of fire or electric shock, never connect power tools, appliances, or extension cords to the fixture.
- Luminaire maintenance should be performed by qualified personnel familiar with the fixture's design and associated risks. Regular maintenance is recommended.
- Do not exceed the specified voltage or current ratings.
- Always turn off power at the breaker or fuse box before installation or maintenance.
- Wear rubber-soled shoes and use a sturdy, non-conductive (wood or fiberglass) ladder during installation.
- Install in accordance with the National Electrical Code (NEC) and local building codes. Improper installation may create safety hazards.
- Keep all components and packaging out of reach of children. Dispose of materials properly.
- Clean the lens or diffuser as needed based on dirt accumulation and desired light output. Use warm water and a mild, non-abrasive detergent. Rinse thoroughly and dry. Replace damaged gaskets if the interior requires cleaning.
- Contact manufacturer with any installation questions.
- Do not install if any components appear damaged. This product is packaged to prevent damage during shipping—inspect all parts before installation and replace any damaged components.
- These instructions do not cover every possible installation scenario. For additional support or if unique conditions arise, contact the manufacturer.

### WARNING RISK OF FIRE - Important Wiring Guidelines

- Many homes built before 1985 use supply wiring rated for 140°F (60°C). Confirm wiring compatibility before installation.
- Always consult a qualified electrician.
- Ensure the electrical enclosure is properly grounded.
- To prevent damage or abrasion, do not route wiring against sharp edges such as sheet metal.
- Use only UL-listed wire connectors for all input and output connections.
- Minimum wire size: 18 AWG. Use 14 AWG for continuous runs.
- When installing fixtures in a continuous run, do not exceed the maximum number of fixtures or total load allowed.
- Electricians must account for inrush current when designing the circuit to avoid overloading.
- Operating ambient temperature range: -13°F thru 122°F
- Suitable for wet locations.

### GENERAL INFORMATION



**WARNING DISCONNECT POWER BEFORE INSTALLING OR SERVICING.**

### TOOLS



Hammer

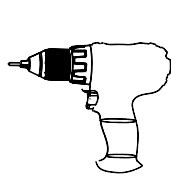

Drill



Flat-head  
screwdriver



Phillips  
screwdriver

### SPEC-SELECT™ FIXTURES - FIELD ADJUSTABLE WATTAGE & CCT

1. Use a Phillips screwdriver to remove the back plate.
2. Adjust the CCT and wattage using the DIP switches to the desired settings.
3. Reattach the back plate, ensuring the silicone pad remains in its original position and rubber o-rings are intact on the screws, to maintain the waterproof seal.

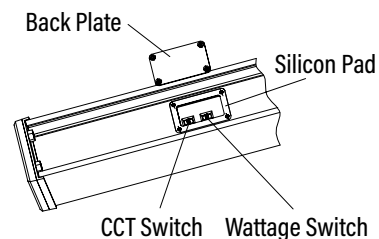

# LINEAR ARCHITECTURAL/WET LOCATION

## INSTALLATION INSTRUCTIONS



### INSTALLATION - WALL MOUNT *(Purchased separately)*



**WARNING DISCONNECT POWER BEFORE INSTALLING OR SERVICING.**

LRW-WMK

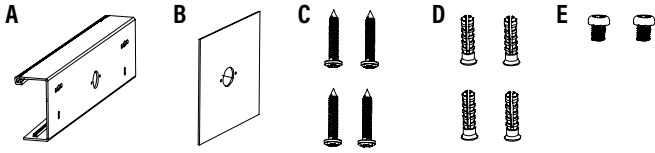

- A: Wall Mount Bracket
- B: Junction Box Cover
- C: 4x30mm Screws (4 ea.)
- D: Anchors (4 ea.)
- E: 4x6mm Screws (2 ea.)

**4** Connect the input wire to the main power supply.

- Line (Black)
- Neutral (White)
- Ground (Green)
- Dim + (Purple)
- Dim - (Pink)

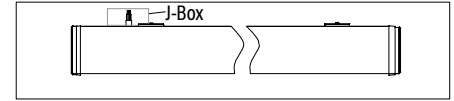

**5** Tilt the fixture and hook its top edge onto the upper section of the wall mount bracket. Once engaged, pivot the bottom of the fixture toward the wall until the fixture is fully seated and hanging securely from the bracket.

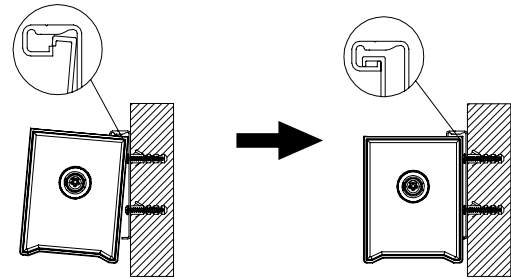

**6** Secure the fixture by tightening the 4x6mm screws on the wall mount bracket.

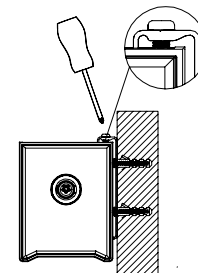

**7** Installation complete, restore power.

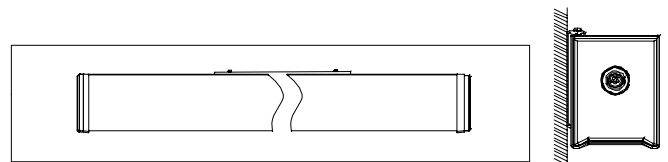

**1** Attach junction box cover to wall mount bracket with 4x6mm screws.

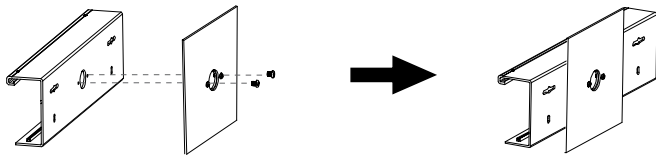

**2** Drill four 5 mm diameter holes at the designated mounting locations, then insert an anchor into each hole.

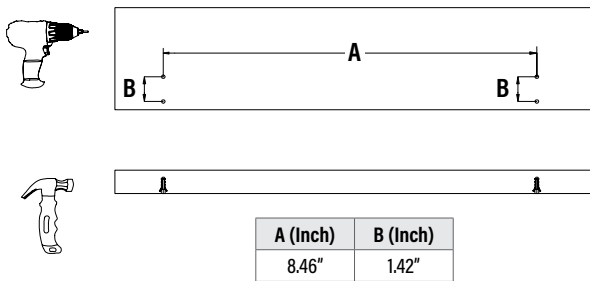

**3** Secure the wall mount bracket using the or 4x30mm screws.

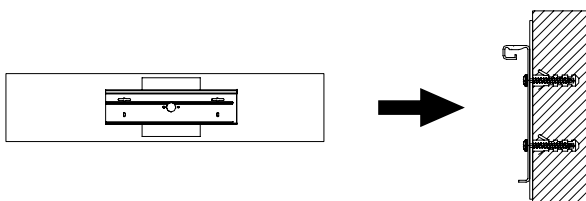

# LINEAR ARCHITECTURAL/WET LOCATION

## INSTALLATION INSTRUCTIONS



### INSTALLATION - STEM MOUNT *(Purchased separately)*



#### LRW-[2,4,8]-STMK

Installer Provided - Toggle Bolts

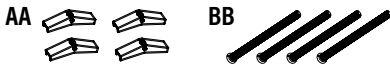

Kit Includes

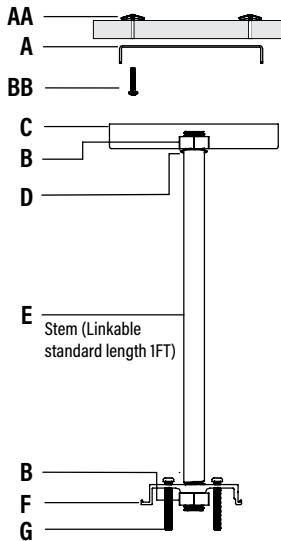
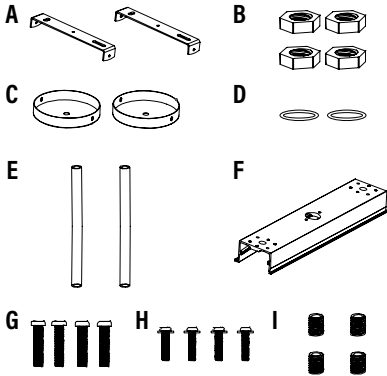

- AA: Toggle Wings (4 ea.)
- BB: Bolts (4 ea.)
- A: Canopy Bracket (2 ea.)
- B: M10 Nut (4 ea.)
- C: Canopy (2 ea.)
- D: Silicone O-Rings (2 ea.)
- E: 1FT Stem (2 ea.)
- F: Mounting Bracket
- G: 4x50mm Screws (4 ea.)
- H: 4x8mm Screws (4 ea.)
- I: 10x20mm Cored Screws (4 ea.)

**1** Drill four holes at the designated mounting locations.

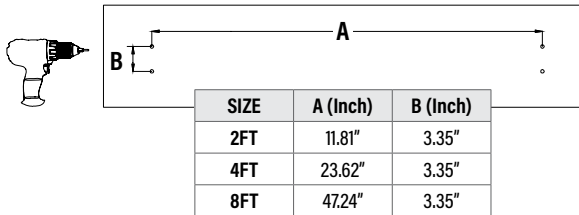

**2** Secure the brackets to the ceiling with installer-provided toggle bolts.

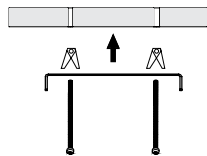

**3a** Install the 10x20mm cored screws into both ends of the stem.

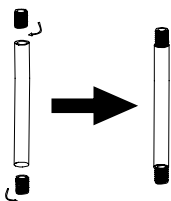

**3b** Install the 4x50mm Screws into mounting bracket.

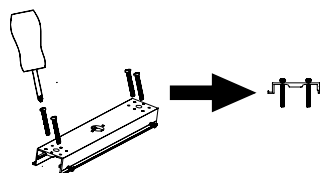

**4** Attach each canopy to its stem using the supplied M10 nut. Install the silicone O-ring onto the stem, then secure the canopy-and-stem assembly to the mounting bracket using the second M10 nut.

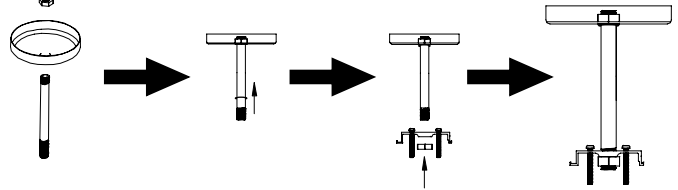

**5** Attach the canopy to the canopy brackets using the 4x8mm screws and silicone o-ring.

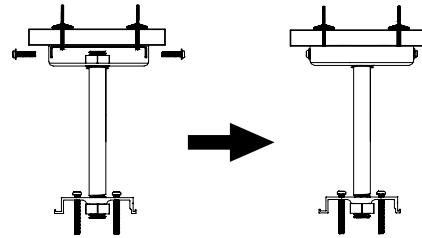

**6** Connect the input wire to the main power supply.

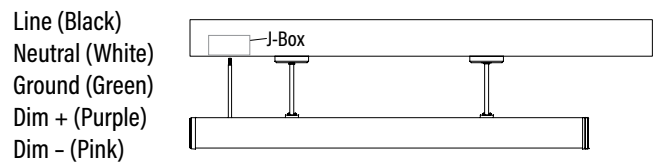

**7** Tilt the fixture and position the higher side onto side A of the bracket, keeping it close. Lift the opposite side of the fixture toward side B of the bracket. Secure the fixture by tightening the screws on the mounting bracket.

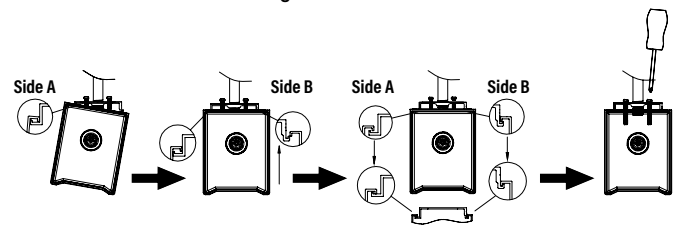

**8** Installation complete, restore power.

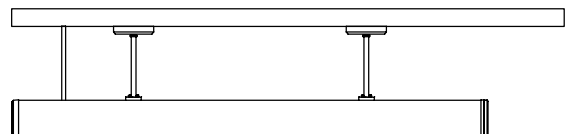

# LINEAR ARCHITECTURAL/WET LOCATION

## INSTALLATION INSTRUCTIONS



### INSTALLATION - SURFACE MOUNT *(Purchased separately)*

**WARNING DISCONNECT POWER BEFORE INSTALLING OR SERVICING.**

LRW-SMK

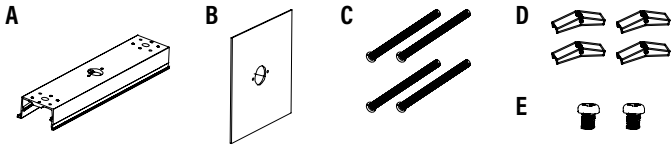

- A: Surface Mount Bracket
- B: Junction Box Cover
- C: Bolts (4 ea.)
- D: Toggle Wings (4 ea.)
- E: 4x6mm Screws (2 ea.)

**4** Connect the input wire to the main power supply.

Line (Black)  
Neutral (White)  
Ground (Green)  
Dim + (Purple)  
Dim - (Pink)

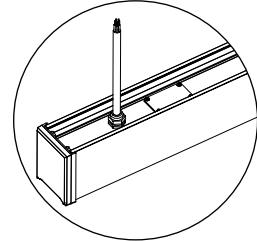

**1** Attach junction box cover to surface mount bracket with 4x6mm screws.

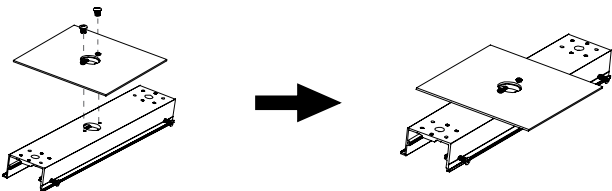

**5** Tilt the fixture and position the higher side onto side A of the bracket, keeping it close. Lift the opposite side of the fixture toward side B of the bracket.

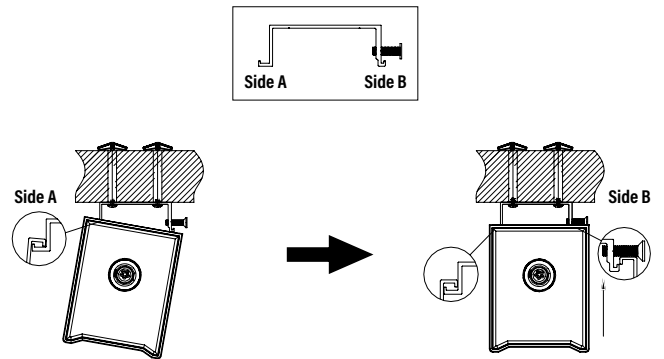

**2** Drill four holes at the designated mounting locations.

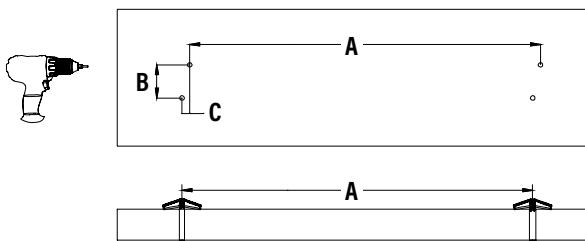

A (Inch)	B (Inch)	C (Inch)
10.43"	1.18"	0.79"

**6** Secure the fixture by tightening the screws on the bracket.

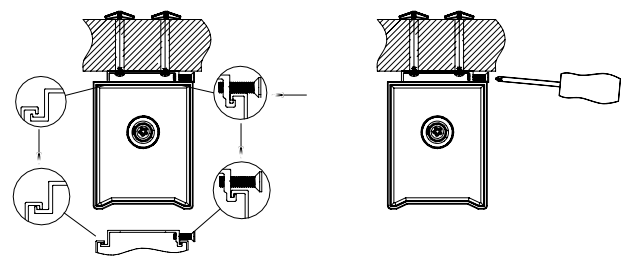

**3** Secure the bracket to the ceiling with toggle bolts.

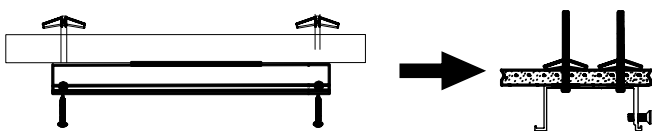

**7** Installation complete, restore power.

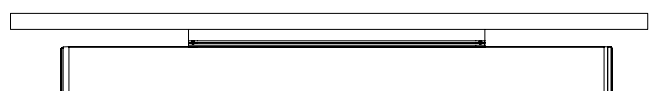

# LINEAR ARCHITECTURAL/WET LOCATION

## INSTALLATION INSTRUCTIONS



### INSTALLATION - RECESSED MOUNT *(Purchased separately)*

**WARNING DISCONNECT POWER BEFORE INSTALLING OR SERVICING.**

LRW-[2,4,8]-RMK

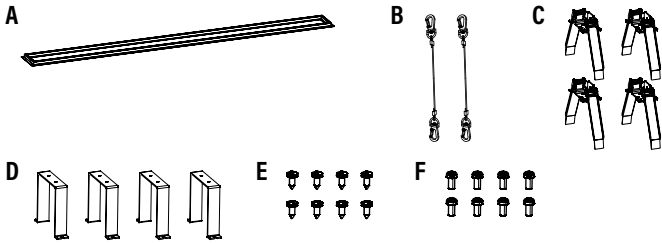

- A: Recessed Frame
- B: Safety Cable (2 ea.)
- C: Spring Clips (4 ea.)
- D: Brackets (4 ea.)
- E: 3.5x8mm Screws (8 ea.)
- F: 4x8mm Screws (8 ea.)

**1** Place the fixture in the recessed frame.

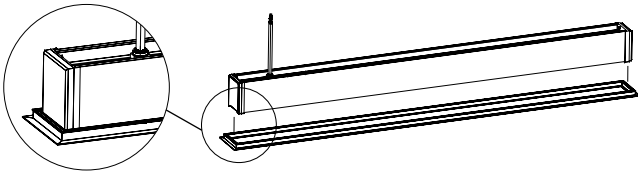

**2** Attach the brackets to the frame.

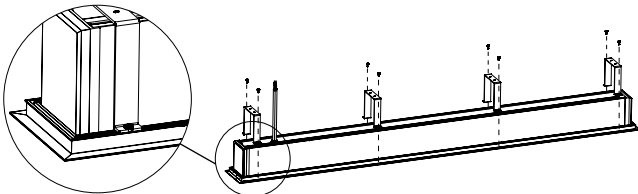

**3** Attach spring clips to brackets.

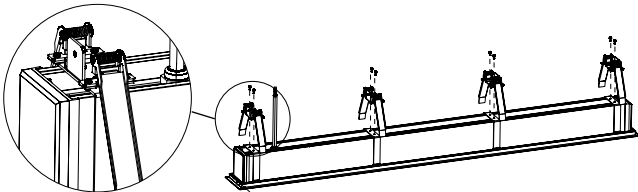

**4** Cut out hole in the mounting surface.

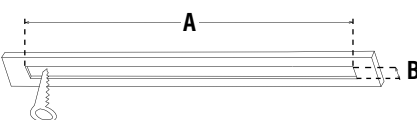

SIZE	A (Inch)	B (Inch)
2FT	25.79"	3.86"
4FT	49.41"	3.86"
8FT	96.65"	3.86"

**5** Lift the spring clips and use cable ties (installer provided) to keep them lifted.

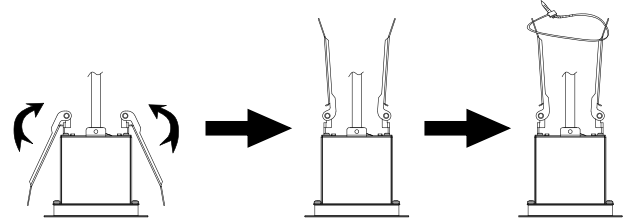

**6** Align the fixture with the pre-cut ceiling opening and insert it into the ceiling. Once the fixture is fully seated, cut and remove the cable ties.

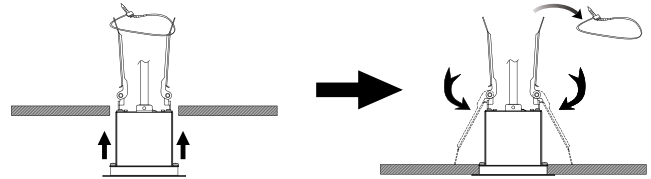

**7** Connect the input wire to the main power supply.

- Line (Black)
- Neutral (White)
- Ground (Green)
- Dim + (Purple)
- Dim - (Pink)

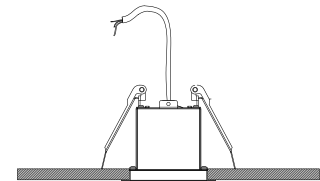

**8** Attach safety cable to fixture.

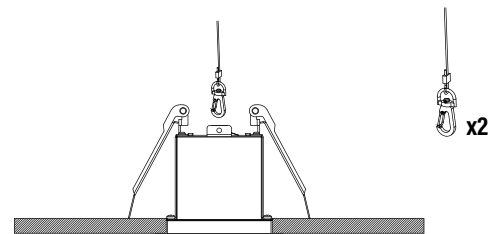

**7** Installation complete, restore power.

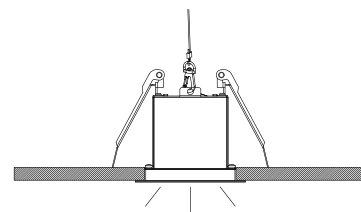

# LINEAR ARCHITECTURAL/WET LOCATION

## INSTALLATION INSTRUCTIONS



**CONTINUOUS RUNS** (For side-exit wiring only; purchased separately.)



**WARNING DISCONNECT POWER BEFORE INSTALLING OR SERVICING.**

LRW-LNK

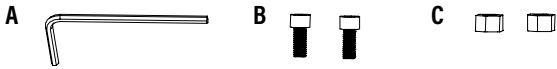

A: Allen Wrench  
B: 5x16mm Screws (2 ea.)  
C: M5 Nut (2 ea.)

- 1** Note: The input side is for incoming power connections. The output side is used for continuous-run installations to connect downstream middle or end fixtures.

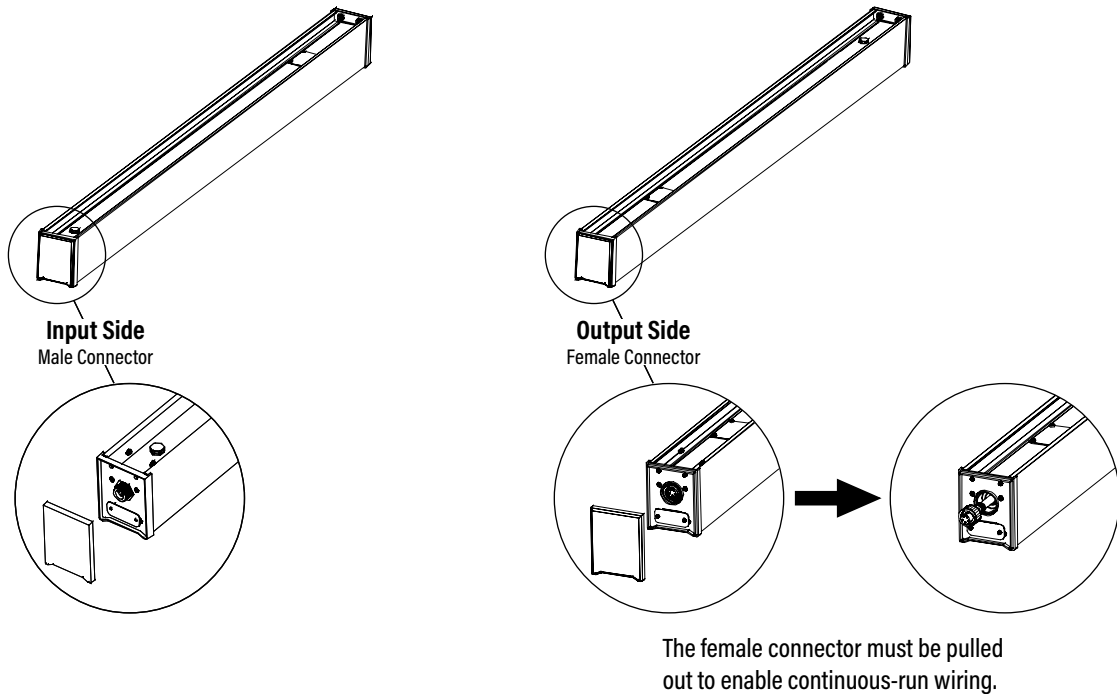

- 2** For middle fixtures, remove both the input-side and output-side end covers. Pull out the female connector from the output side, connect it to the male connector of the next fixture, then secure the connection using the supplied screws and nuts.

