

# LED T8 TONE-SELECT™ SUPER HYBRID

INSTALL INSTRUCTIONS (UL TYPE A & B) FOR LT84H155CS2

**PQL**  
PREMIUM QUALITY LIGHTING®

**PLEASE USE A QUALIFIED ELECTRICIAN FOR INSTALLATION.** Read the instructions before installing or use of the linear tube(s).

**GENERAL:** ALL ELECTRICAL CONNECTIONS MUST BE IN ACCORDANCE WITH LOCAL AND NATIONAL ELECTRICAL CODE (N.E.C.) STANDARDS. IF YOU ARE UNFAMILIAR WITH PROPER ELECTRICAL WIRING CONNECTIONS OBTAIN THE SERVICES OF A QUALIFIED ELECTRICIAN. REMOVE THE TRIM FROM THE BOX AND MAKE SURE THAT NO PARTS ARE MISSING.

## SAFETY INFORMATION

- Check the lamp before installation, if there is any damage caused during transportation, do not install.
- Maintenance should be carried out by technical personnel only.
- Do not stare and the light source with bare eyes or long periods of time, do not shine into others eyes.
- Do not place objects on the lamp.
- Keep lamp away from flames or high temperature objects.
- Risk of electrical shock - Only replace with same type of LED tube.
- If the glass lamp tube is broken, the lamp must be disposed of immediately.
- To prevent early lamp failure, install only in environments with temperatures between -4°F and +113°F.
- Suitable for damp locations, IP20.

## OPERATIONAL MODES

**Mode I:** Direct replacement, Plug & Go™, compatible with most instant start electronic ballasts, see ballast compatibility list.

**Mode II:** Direct wire, bypass, directly connects to the main: 120-277V • 50/60Hz, single or double ended.

## DIRECT REPLACEMENT (Plug & Go™) INSTRUCTIONS



**WARNING DISCONNECT POWER BEFORE INSTALLING OR SERVICING.**

**To avoid personal injury and/or possible product damage, the following cautions must be followed:**

- Read all safety information and instructions before installation.
- RISK OF ELECTRIC SHOCK. Disconnect power at the fuse or circuit breaker before installing or servicing.
- Suitable for damp locations. Not for use where directly exposed to water.
- Caution: Only use the control provided with or specified by these instructions to control this lamp. This lamp will not operate properly when connected to a standard (incandescent) dimmer or dimming control.
- This device is not intended for use with emergency exits.
- CAUTION - RISK OF FIRE. USE ONLY IN PLACE OF FLUORESCENT LAMPS SPECIFIED ON THE PRODUCT LABEL.
- CAUTION - RISK OF FIRE. IF THE LAMP OR LUMINAIRE EXHIBITS UNDESIRABLE OPERATION (BUZZING, FLICKERING, ETC.), IMMEDIATELY TURN OFF POWER, REMOVE THE LAMP FROM THE LUMINAIRE, AND CONTACT THE MANUFACTURER.
- CAUTION - RISK OF FIRE. IF THE LAMP DOES NOT LIGHT WHEN THE LUMINAIRE IS ENERGIZED, REMOVE THE LAMP FROM THE LUMINAIRE AND CONTACT THE LAMP MANUFACTURER OR A QUALIFIED ELECTRICIAN.
- CAUTION - RISK OF FIRE OR ELECTRIC SHOCK. When working with an electronic ballast, check the compatibility list first. If your ballast is not on the list, bypass the fixture as a Type B installation or contact us for support. Do not install the LED tube with a ballast that is not on the compatibility list.
- To prevent damage to the lamp, it must not be energized when the color (CCT) selector switch is changed.

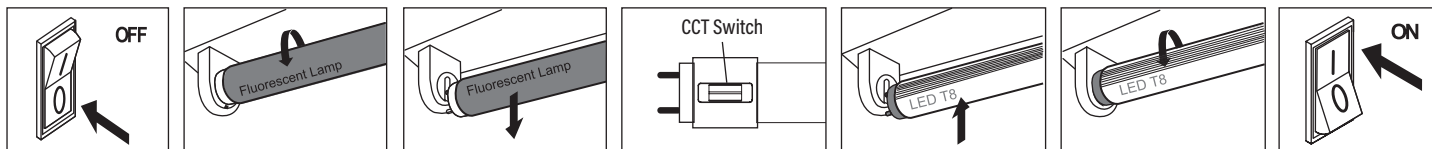
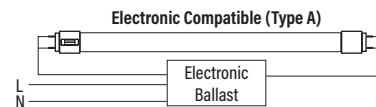

## INSTALLATION

1. Switch off power to the luminaire.
2. Remove the diffuser (if provided).
3. Remove the existing fluorescent lamps from the luminaire.
4. Select the color temperature using the CCT switch on the LED lamp base. To prevent damage to the lamp, do not energize the lamp while changing the color (CCT) selector switch.
5. Install the LED tube lamp. *Note: Install one LED T8 replacement lamp for each fluorescent lamp removed.*

6. Risk of fire: Ensure the tube is properly installed. The end caps are marked to indicate correct alignment with the sockets. Make sure the markings match the socket orientation as shown to the right.
7. Reinstall the diffuser (if removed in Step 2).
8. Switch on power to the luminaire.

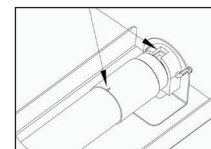

# LED T8 TONE-SELECT™ SUPER HYBRID

INSTALL INSTRUCTIONS (UL TYPE A & B) FOR LT84H155CS2



## DIRECT WIRE (Bypass) INSTRUCTIONS



**WARNING DISCONNECT POWER BEFORE INSTALLING OR SERVICING.**

**To avoid personal injury and/or possible product damage, the following cautions must be followed:**

- Read all safety information and instructions before installation.
- **RISK OF ELECTRIC SHOCK:** Disconnect power at the fuse or circuit breaker before installing or servicing.
- To prevent damage to the lamp, do not energize it while changing the color (CCT) selector switch.
- Suitable for damp locations. Not for use in areas directly exposed to water.
- Caution: Use only the control provided with or specified in these instructions to operate this lamp. This lamp will not operate properly when connected to a standard (incandescent) dimmer or dimming control.
- This device is not intended for use with emergency exit fixtures.
- To prevent early lamp failure, install only in environments with temperatures between -4°F and +113°F.
- **WARNING - RISK OF FIRE OR ELECTRIC SHOCK:** Installation of the LED retrofit kit requires knowledge of luminaire electrical systems. If you are not qualified, do not attempt installation. Contact a qualified electrician.
- **WARNING - RISK OF FIRE OR ELECTRIC SHOCK:** Install this kit only in luminaires with the construction features and dimensions shown in the photographs and/or drawings, and where the input rating of the retrofit kit does not exceed the input rating of the luminaire.
- Do not make or alter any open holes in the enclosure of wiring or electrical components during installation.
- **WARNING:** To prevent wiring damage or abrasion, do not expose wiring to sheet metal edges or other sharp objects.
- Do not disconnect existing wires from lamp socket terminals to make new connections. Instead, cut the existing lamp socket leads away from the lamp sockets and make new electrical connections using connectors suitable for the application.
- This retrofit kit is accepted as a component of a luminaire, where the suitability of the combination shall be determined by authorities having jurisdiction. The product must be installed by a qualified electrician in accordance with applicable electrical codes. This installation guide does not supersede local or national regulations.
- Inspect all parts not replaced by the retrofit kit for damage. Replace any damaged parts prior to installation.
- This tube is installed as Type B. Once modified, the luminaire will no longer operate fluorescent lamps.
- Connect the two wires to the branch circuit's L and N terminals as shown in the figures below.

**SINGLE-ENDED** - Input Voltage 120-277V, the socket should be non-shunted.



**DOUBLE-ENDED** - Input voltage: 120-277V. No need to replace sockets or lamp holders, provided they are in good condition, regardless of socket type.



**REVERSE PHASE DIMMING** - Input voltage: 120V only.

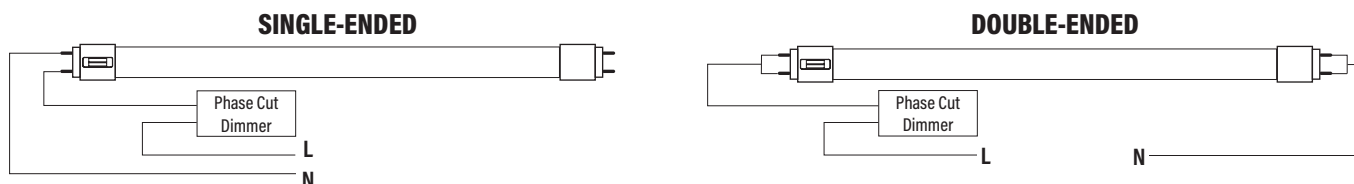

COMPATIBLE LUTRON DIMMERS		
DVELV-300P-BR	DVELV-303P-GR	MAELV-600-BR
DVELV-300P-GR	DVELV-303P-IV	MAELV-600-GR
DVELV-300P-IV	DVELV-303P-LA	MAELV-600-IV
DVELV-300P-LA	DVELV-303P-WH	MAELV-600-LA
DVELV-300P-WH	MAELV-600-AL	MAELV-600-WH
DVELV-303P-BR	MAELV-600-BL	

# LED T8 TONE-SELECT™ SUPER HYBRID

INSTALL INSTRUCTIONS (UL TYPE A & B) FOR LT84H155CS2

**PQL**  
PREMIUM QUALITY LIGHTING®

## DIRECT WIRE (Bypass) INSTRUCTIONS



**WARNING DISCONNECT POWER  
BEFORE INSTALLING OR SERVICING.**

### INSTALLATION

1. Disconnect power before installation.

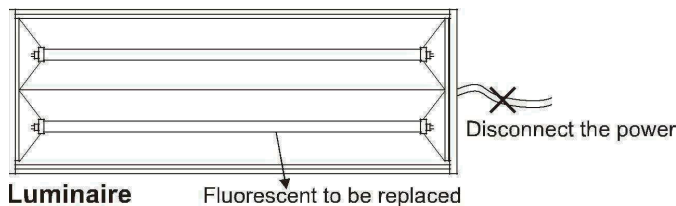

2. Remove the diffuser (if provided).
3. Remove the existing fluorescent lamps from the luminaire.

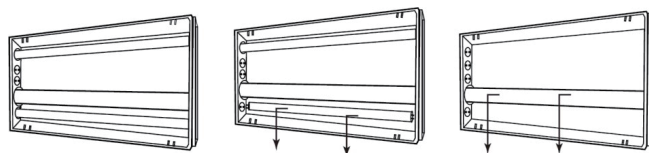

4. Remove the ballast cover (may be secured with screws or tabs).
5. Modify the circuit according to the Type B wiring diagram on page 2.
6. Select the color temperature using the CCT switch on the LED lamp base. To prevent damage to the lamp, do not energize the lamp while changing the color (CCT) selector switch.

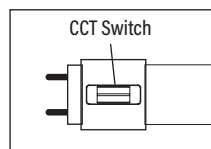

7. Risk of fire: Ensure the tube is properly installed. The end caps are marked to indicate correct alignment with the sockets. Make sure the markings match the socket orientation as shown to the right.
8. After completing the modification, attach the replacement caution label in a visible location on the luminaire. Ensure it remains visible after installation. Mark the wiring type (single- or double-ended) on the label.
9. Reinstall the diffuser (if removed in Step 2).
10. Restore power to the circuit/luminaire and test the light. If necessary, adjust the position of the LED tube.

Note: This product complies with Part 18 of the FCC rules but may cause interference to radios, televisions, wireless telephones and remote controls. If interference occurs, move the product away from these devices or plug it into a different outlet. Do not install this product near maritime safety communications equipment or other critical navigation or communication equipment operating between 0.45-30MHz

Note: This equipment has been tested and found to comply with the limits for a Class B digital device, pursuant to Part 15 of the FCC Rules. These limits are designed to provide reasonable protection against harmful interference in a residential installation. This equipment generates, uses, and can radiate radio frequency energy and, if not installed and used in accordance with the instructions, may cause harmful interference to radio communications. However, there is no guarantee that interference will not occur in a particular installation. If this equipment does cause harmful interference to radio or television reception, which can be determined by turning the equipment off and on, the user is encouraged to try to correct the interference by one or more of the following measures:

- Reorient or relocate the receiving antenna.
- Increase the separation between the equipment and receiver.
- Connect the equipment into an outlet on a circuit different from that to which the receiver is connected.
- Consult the dealer or an experienced radio/TV technician for help. This Class B digital apparatus complies with Canadian ICES-005.